

Zahnwellen

Zahnwellen T5

Zahnwellen T10

Zahnwellen AT5

Zahnwellen AT10

Zahnwellen 5M

Zahnwellen 8M

Sonderanfertigungen nach Zeichnung sowie
Standardteile einbaufertig bearbeitet,
auf Wunsch mit Wärme- und/oder Oberflächenbehandlung

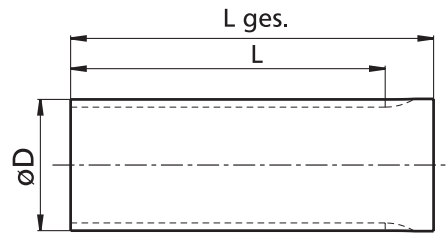

Zahnwellen T5

G&G-Best.-Nr.	Zz	øD	L	L.ges
825-001-0010	10	15,05	140	140
825-001-0011	11	16,65	140	140
825-001-0012	12	18,25	140	140
825-001-0013	13	19,85	140	140
825-001-0014	14	21,45	140	140
825-001-0015	15	23,05	140	140
825-001-0016	16	24,60	140	140
825-001-0017	17	26,20	140	140
825-001-0018	18	27,80	140	140
825-001-0019	19	29,40	140	140
825-001-0020	20	31,00	160	160
825-001-0021	21	32,70	160	160
825-001-0022	22	34,25	160	160
825-001-0023	23	35,85	160	160
825-001-0024	24	37,40	160	160
825-001-0025	25	38,95	160	160
825-001-0026	26	40,60	160	160
825-001-0027	27	42,20	160	160
825-001-0028	28	43,75	160	160
825-001-0029	29	45,35	160	160

G&G-Best.-Nr.	Zz	øD	L	L.ges
825-001-0030	30	46,95	160	160
825-001-0032	32	50,10	160	160
825-001-0034	34	53,25	160	160
825-001-0035	35	54,85	160	160
825-001-0036	36	56,45	160	160
825-001-0037	37	58,06	160	160
825-001-0038	38	59,65	160	160
825-001-0040	40	62,85	160	160
825-001-0042	42	66,00	160	160
825-001-0044	44	69,20	160	160
825-001-0045	45	70,80	160	160
825-001-0046	46	72,40	160	160
825-001-0048	48	75,55	160	160
825-001-0050	50	78,75	160	160
825-001-0060	60	94,65	160	160
825-001-0072	72	113,75	160	160
825-001-0080	80	126,48	160	160
825-001-0090	90	142,40	160	160
825-001-0100	100	158,31	160	160

T5 – Teilung 5 mm

Material: Aluminium

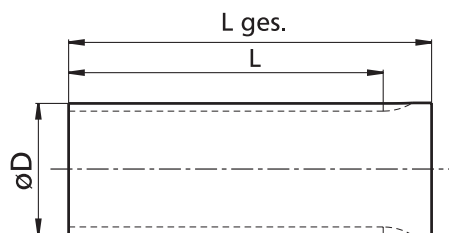

Zahnwellen T10

G&G-Best.-Nr.	Zz	øD	L	L.ges
825-002-0010	10	29,98	140	140
825-002-0011	11	33,16	140	140
825-002-0012	12	36,35	140	140
825-002-0013	13	39,55	140	140
825-002-0014	14	42,70	160	160
825-002-0015	15	45,90	160	160
825-002-0016	16	49,10	160	160
825-002-0017	17	52,25	160	160
825-002-0018	18	55,45	160	160
825-002-0019	19	58,65	160	160
825-002-0020	20	61,80	160	160
825-002-0021	21	65,00	160	160
825-002-0022	22	68,20	160	160
825-002-0023	23	71,35	160	160

G&G-Best.-Nr.	Zz	øD	L	L.ges
825-002-0024	24	74,55	160	160
825-002-0026	26	80,90	160	160
825-002-0028	28	87,25	160	160
825-002-0030	30	93,65	160	160
825-002-0032	32	100,00	160	160
825-002-0034	34	106,40	160	160
825-002-0036	36	112,75	160	160
825-002-0038	38	119,10	160	160
825-002-0040	40	125,45	160	160
825-002-0045	45	141,40	160	160
825-002-0048	48	150,95	160	160
825-002-0060	60	189,15	160	160
825-002-0072	72	227,29	160	160

T10 – Teilung 10 mm

Material: Aluminium

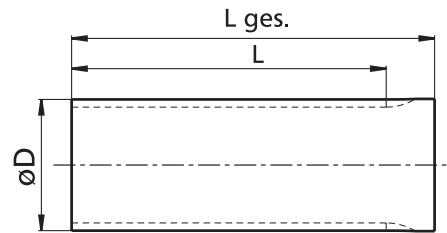

Zahnwellen AT5

G&G-Best.-Nr.	Zz	øD	L	L.ges
825-003-0012	12	17,85	140	140
825-003-0013	13	19,45	140	140
825-003-0014	14	21,05	140	140
825-003-0015	15	22,65	140	140
825-003-0016	16	24,20	140	140
825-003-0017	17	25,80	140	140
825-003-0018	18	27,40	140	140
825-003-0019	19	29,00	140	140
825-003-0020	20	30,60	160	160
825-003-0021	21	32,30	160	160
825-003-0022	22	33,85	160	160
825-003-0023	23	35,45	160	160
825-003-0024	24	37,00	160	160
825-003-0025	25	38,55	160	160
825-003-0026	26	40,20	160	160
825-003-0027	27	41,80	160	160
825-003-0028	28	43,35	160	160

G&G-Best.-Nr.	Zz	øD	L	L.ges
825-003-0030	30	46,55	160	160
825-003-0032	32	49,70	160	160
825-003-0034	34	52,85	160	160
825-003-0036	36	56,05	160	160
825-003-0038	38	59,25	160	160
825-003-0040	40	62,45	160	160
825-003-0042	42	65,60	160	160
825-003-0044	44	68,80	160	160
825-003-0046	46	72,00	160	160
825-003-0048	48	75,15	160	160
825-003-0052	52	81,55	160	160
825-003-0056	56	87,90	160	160
825-003-0058	58	91,10	160	160
825-003-0060	60	94,25	160	160
825-003-0064	64	100,65	160	160
825-003-0072	72	113,35	160	160

AT5 – Teilung 5 mm

Material: Aluminium

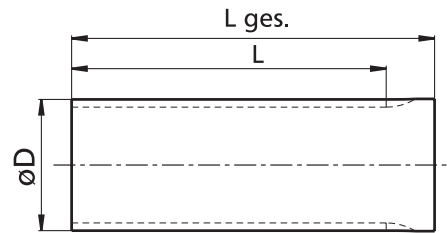

Zahnwellen AT10

G&G-Best.-Nr.	Zz	øD	L	L.ges
825-004-0015	15	45,90	160	160
825-004-0016	16	49,10	160	160
825-004-0017	17	52,25	160	160
825-004-0018	18	55,45	160	160
825-004-0019	19	58,65	160	160
825-004-0020	20	61,80	160	160
825-004-0021	21	65,00	160	160
825-004-0022	22	68,20	160	160
825-004-0023	23	71,35	160	160
825-004-0024	24	74,55	160	160
825-004-0025	25	77,75	160	160
825-004-0026	26	80,90	160	160
825-004-0027	27	84,05	160	160
825-004-0028	28	87,25	160	160
825-004-0030	30	93,65	160	160

G&G-Best.-Nr.	Zz	øD	L	L.ges
825-004-0032	32	100,00	160	160
825-004-0034	34	106,40	160	160
825-004-0036	36	112,75	160	160
825-004-0038	38	119,10	160	160
825-004-0040	40	125,45	160	160
825-004-0042	42	131,85	160	160
825-004-0044	44	138,20	160	160
825-004-0046	46	144,55	160	160
825-004-0048	48	150,95	160	160
825-004-0052	52	163,65	160	160
825-004-0056	56	176,40	160	160
825-004-0058	58	182,75	160	160
825-004-0060	60	189,15	160	160
825-004-0070	70	220,95	160	160

AT10 – Teilung 10 mm

Material: Aluminium

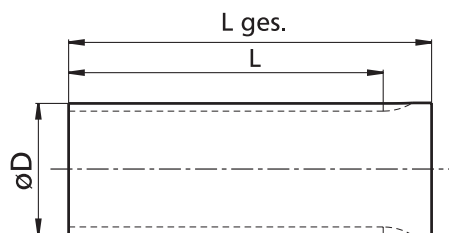

Zahnwellen 5M

G&G-Best.-Nr.	Zz	øD	L	L.ges
825-005-0012	12	17,96	160	160
825-005-0013	13	19,55	160	160
825-005-0014	14	21,14	175	200
825-005-0015	15	22,73	175	200
825-005-0016	16	24,32	175	200
825-005-0017	17	25,92	175	200
825-005-0018	18	27,51	200	200
825-005-0019	19	29,10	200	200
825-005-0020	20	30,69	200	200
825-005-0021	21	32,28	200	200
825-005-0022	22	33,87	200	200
825-005-0023	23	35,47	200	200
825-005-0024	24	37,06	200	200
825-005-0025	25	38,65	200	200
825-005-0026	26	40,24	200	200

G&G-Best.-Nr.	Zz	øD	L	L.ges
825-005-0027	27	41,83	200	200
825-005-0028	28	43,42	200	200
825-005-0030	30	46,61	200	200
825-005-0032	32	49,79	200	200
825-005-0034	34	52,97	200	200
825-005-0036	36	56,16	200	200
825-005-0038	38	59,34	200	200
825-005-0040	40	62,52	200	200
825-005-0042	42	65,71	200	200
825-005-0044	44	68,89	200	200
825-005-0045	45	70,48	200	200
825-005-0048	48	75,25	200	200
825-005-0050	50	78,44	200	200
825-005-0060	60	94,35	200	200
825-005-0072	72	113,45	200	200

5M – Teilung 5 mm

Material: Aluminium

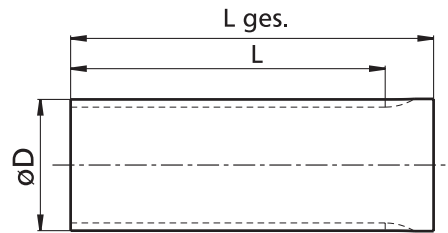

Zahnwellen 8M

G&G-Best.-Nr.	Zz	øD	L	L.ges
825-006-0018	18	44,47	200	200
825-006-0019	19	47,01	200	200
825-006-0020	20	49,56	200	200
825-006-0021	21	52,11	200	200
825-006-0022	22	54,65	200	200
825-006-0023	23	57,20	200	200
825-006-0024	24	59,75	200	200
825-006-0025	25	62,29	200	200
825-006-0026	26	64,84	200	200
825-006-0028	28	69,93	200	200

G&G-Best.-Nr.	Zz	øD	L	L.ges
825-006-0030	30	75,02	200	200
825-006-0032	32	80,12	200	200
825-006-0034	34	85,21	200	200
825-006-0035	35	87,76	200	200
825-006-0036	36	90,30	200	200
825-006-0038	38	95,40	200	200
825-006-0040	40	100,49	200	200
825-006-0044	44	110,68	200	200
825-006-0048	48	120,86	200	200

8M – Teilung 8 mm

Material: C45