

Kettenräder gehärtet - simplex

GG-Bestell-Nr.	Zz	D _K	D	L	N _b	D _L
501-101-0412	12	40.0	36.80	25	25	8
501-101-0413	13	43.0	39.80	25	28	10
501-101-0414	14	46.3	42.80	25	31	10
501-101-0415	15	49.3	45.81	25	34	10
501-101-0416	16	52.3	48.82	28	37	10
501-101-0417	17	55.3	51.83	28	40	10
501-101-0418	18	58.3	54.85	28	43	10
501-101-0419	19	61.3	57.87	28	45	10
501-101-0420	20	64.3	60.89	28	46	10
501-101-0421	21	68.0	63.91	28	48	12
501-101-0422	22	71.0	66.93	28	50	12
501-101-0423	23	74.0	69.95	28	52	12
501-101-0424	24	77.0	72.97	28	54	12
501-101-0425	25	80.0	76.00	28	57	12
501-101-0430	30	94.7	91.12	28	60	12

Rollenkette DIN 8187

06 B-1	Teilung	9,525mm
3/8 x 7/32"	Innere Breite	5,72mm
9,525 x 5,72mm	Rollen ø	6,35mm

Kettenrad DIN 8196

Zahnbreite B1	5,3mm
Werkstoff:	C45 - gehärtet

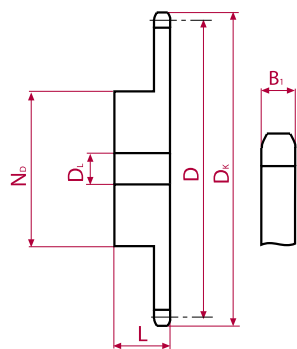

Kettenräder gehärtet - simplex

GG-Bestell-Nr.	Zz	D _K	D	L	N _b	D _L
501-201-0412	12	53.90	49.07	28	33	10
501-201-0413	13	58.40	53.06	28	37	10
501-201-0414	14	62.80	57.07	28	41	10
501-201-0415	15	66.80	61.09	28	45	10
501-201-0416	16	70.90	65.10	28	50	12
501-201-0417	17	74.90	69.11	28	52	12
501-201-0418	18	78.90	73.14	28	56	12
501-201-0419	19	82.90	77.16	28	60	12
501-201-0420	20	86.90	81.19	28	64	12
501-201-0421	21	91.00	85.22	28	68	12
501-201-0422	22	95.00	89.24	28	70	12
501-201-0423	23	99.00	93.27	28	70	14
501-201-0424	24	103.00	97.29	28	70	14
501-201-0425	25	107.10	101.33	28	70	14
501-201-0430	30	127.50	121.50	90	80	16

Rollenkette DIN 8187

08 B-1	Teilung	12,7mm
1/2 x 5/16"	Innere Breite	7,75mm
12,7 x 7,75mm	Rollen ø	8,51mm

Kettenrad DIN 8196

Zahnbreite B1	7,2mm
Werkstoff:	C45 - gehärtet

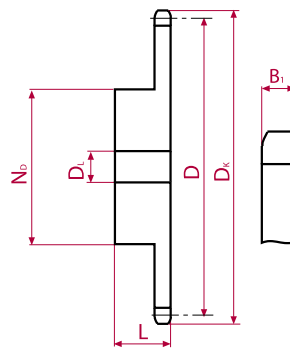

Kettenräder gehärtet - simplex

GG-Bestell-Nr.	Zz	D _K	D	L	N _b	D _L
501-301-0412	12	68.0	61.34	30	42	12
501-301-0413	13	73.0	66.32	30	47	12
501-301-0414	14	78.0	71.34	30	52	12
501-301-0415	15	83.0	76.36	30	57	12
501-301-0416	16	88.0	81.37	30	60	12
501-301-0417	17	93.0	86.39	30	60	12
501-301-0418	18	98.3	91.42	30	70	14
501-301-0419	19	103.3	96.45	30	70	14
501-301-0420	20	108.4	101.49	30	75	14
501-301-0421	21	113.4	106.52	30	75	16
501-301-0422	22	118.0	111.55	30	80	16
501-301-0423	23	123.4	116.58	30	80	16
501-301-0424	24	128.3	121.62	30	80	16
501-301-0425	25	134.0	126.66	30	80	16
501-301-0430	30	158.8	151.17	35	90	20

Rollenkette DIN 8187

10 B-1	Teilung	15,875mm
5/8 x 3/8"	Innere Breite	9,65mm
15,875 x 9,65mm	Rollen ø	10,16mm

Kettenrad DIN 8196

Zahnbreite B1	9,1mm
Werkstoff:	C45 - gehärtet

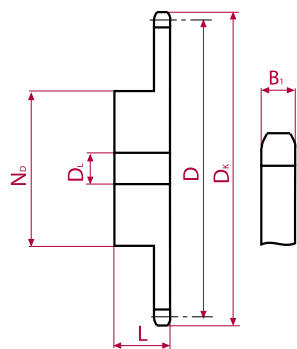

Kettenräder gehärtet - simplex

GG-Bestell-Nr.	Zz	D _K	D	L	N _b	D _L
501-401-0412	12	81.5	73.60	35	52	14
501-401-0413	13	87.5	79.59	35	58	14
501-401-0414	14	93.6	85.61	35	64	14
501-401-0415	15	99.8	91.63	35	70	14
501-401-0416	16	105.5	97.65	35	75	16
501-401-0417	17	111.5	103.67	35	80	16
501-401-0418	18	118.0	109.71	35	80	16
501-401-0419	19	124.2	115.75	35	80	16
501-401-0420	20	129.7	121.78	35	80	16
501-401-0421	21	136.0	127.82	40	90	20
501-401-0422	22	141.8	133.86	40	90	20
501-401-0423	23	149.0	139.90	40	90	20
501-401-0424	24	153.9	145.94	40	90	20
501-401-0425	25	160.0	152.00	40	90	20
501-401-0430	30	190.5	182.25	40	95	20

Rollenkette DIN 8187

12 B-1	Teilung	19,05mm
3/4 x 7/16"	Innere Breite	11,68mm
19,05 x 11,68mm	Rollen ø	12,07mm

Kettenrad DIN 8196

Zahnbreite B1	11,1mm
Werkstoff:	C45 - gehärtet

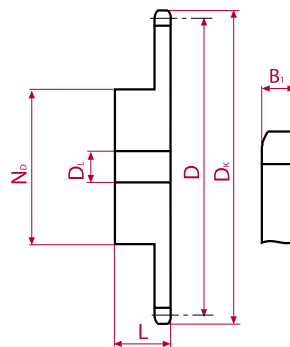

Kettenräder gehärtet - simplex

GG-Bestell-Nr.	Zz	D _K	D	L	N _b	D _L
501-501-0412	12	109.0	98.14	40	69	16
501-501-0413	13	117.0	106.12	40	78	16
501-501-0414	14	125.0	114.15	40	84	16
501-501-0415	15	133.0	122.17	40	92	16
501-501-0416	16	141.0	130.20	45	100	20
501-501-0417	17	149.0	138.22	45	100	20
501-501-0418	18	157.0	146.28	45	100	20
501-501-0419	19	165.2	154.33	45	100	20
501-501-0420	20	173.2	162.38	45	100	20
501-501-0421	21	181.2	170.43	50	110	20
501-501-0422	22	189.3	178.48	50	110	20
501-501-0423	23	197.5	186.53	50	110	20
501-501-0424	24	205.5	194.59	50	110	20
501-501-0425	25	213.5	202.66	50	110	20
501-501-0430	30	254.0	243.00	50	120	20

Rollenkette DIN 8187

16 B-1	Teilung	25,40mm
1" x 17,02mm	Innere Breite	17,02mm
25,4 x 17,02mm	Rollen ø	15,88mm

Kettenrad DIN 8196

Zahnbreite B1	16,2mm
Werkstoff:	C45 - gehärtet